

SPECIFICATIONS — MARINE VALVES JIS STANDARD

CAST IRON SCREW DOWN CHECK ANGLE VALVE

MATERIALS TABLE

ITEM NO	NAME OF PART	MATERIAL	
		CLASS B	CLASS S
1	BODY	FC200	
2	BONNET	FC200	
3	DISC	BC6	SCS2
4	VALVE SEAT	BC6	SCS2
5	STEM	BC6	SUS403
6	PACKING	2Cr13/SS420	
7	GASKET	NON ASBESTOS	
8	HANDWHEEL	FC200	

TYPE OF TEST	TYPE OF VALVES		
	F7354	F7376	F7378
WORKING PRESSURE	5 kg/cm ² (0.49Mpa)	10 kg/cm ² (0.98Mpa)	16 kg/cm ² (1.56Mpa)
BODY TEST	10.5 kg/cm ² (1.03Mpa)	21 kg/cm ² (2.06Mpa)	33 kg/cm ² (3.24Mpa)
SEAT TEST	7.7 kg/cm ² (0.761Mpa)	15.4 kg/cm ² (1.522Mpa)	24.2 kg/cm ² (2.38Mpa)

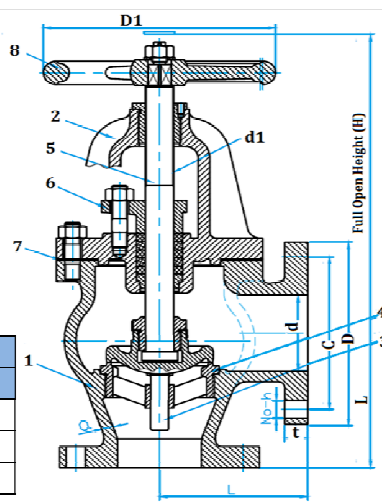

SIZE TABLE

F7354 CAST IRON 5K SCREW DOWN CHECK ANGLE VALVE - SIZE TABLE

DN	d	L	D	C	NO	h	t	H	D1
50	50	100	130	105	4	15	16	240	160
65	65	115	155	130	4	15	18	245	180
80	80	130	180	145	4	19	18	255	180
100	100	150	200	165	8	19	20	300	224
125	125	170	235	200	8	19	20	320	250
150	150	190	265	230	8	19	22	365	280
200	200	220	320	280	8	23	24	425	315
250	250	275	385	345	12	23	26	510	355
300	300	310	430	390	12	23	28	585	400
350	335	360	480	435	12	25	30	660	500
400	380	395	540	495	16	25	30	730	560
450	430	440	605	555	16	25	30	835	630

F7376 CAST IRON 10K SCREW DOWN CHECK ANGLE VALVE - SIZE TABLE

DN	d	L	D	C	NO	h	t	H	D2
50	50	120	155	120	4	19	20	255	160
65	65	130	175	140	4	19	22	260	200
80	80	140	185	150	8	19	22	270	200
100	100	160	210	175	8	19	24	305	250
125	125	180	250	210	8	23	24	350	280
150	150	205	280	240	8	23	26	390	315
200	200	230	330	290	12	23	26	450	355
250	250	290	400	355	12	25	30	536	450

F7378 CAST IRON 16K SCREW DOWN CHECK ANGLE VALVE - SIZE TABLE

DN	d	L	D	C	NO	h	t	H	D2
50	50	120	155	120	8	19	20	255	160
65	65	130	175	140	8	19	22	260	200
80	80	150	200	160	8	23	24	290	224
100	100	170	225	185	8	23	26	320	250
125	125	200	270	225	8	25	26	375	315
150	150	225	305	260	12	25	28	425	355
200	200	250	350	305	12	25	30	521	450