

SPECIFICATIONS — BALL VALVE

STAINLESS STEEL 316 2PCS BODY BALL VALVE

CHEW SS316 Ball Valve are used for Air, Water, Oil and Acid Piping Systems which are installed where a simple on/off action is needed.

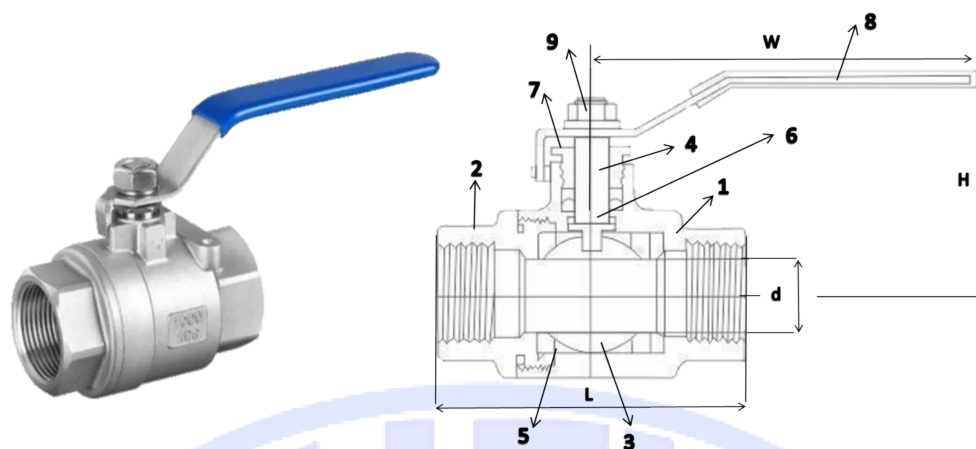

MATERIALS DATA

Size	d	L	H	W
1/4"	11.6	57	49	120
3/8"	12.7	57	49	120
1/2"	15	53	54	120
3/4"	20	64	65	130
1"	25	72	72	154
1-1/4"	32	83	83	154
1-1/2"	38	95	94	185
2"	50	108	107	185
2-1/2"	65	161.5	130	250
3"	80	178	148	250
4"	100	223	200	250

No.	PARTS	MATERIAL
1	BODY	CF8M
2	BONNET	CF8M
3	BALL	SS316
4	STEM	SS316
5	SEAT	RTFE
6	GASKET	PTFE
7	PACKING SLEEVE	SS202
8	HANDLE	SS202
9	NUT	SS202

OPERATING PARAMETER

Nominal Pressure	1.6Mpa
Operating Temperature	-50 to 220 Deg C
Applicable Media	Water, Oil, Air, Acid

SPECIFICATIONS — Y STRAINER

STAINLESS STEEL 316 Y-STRAINER

CHEW SS316 Y-Strainers are devices used to filter or strain out unwanted elements from fluids, steam, or gas .

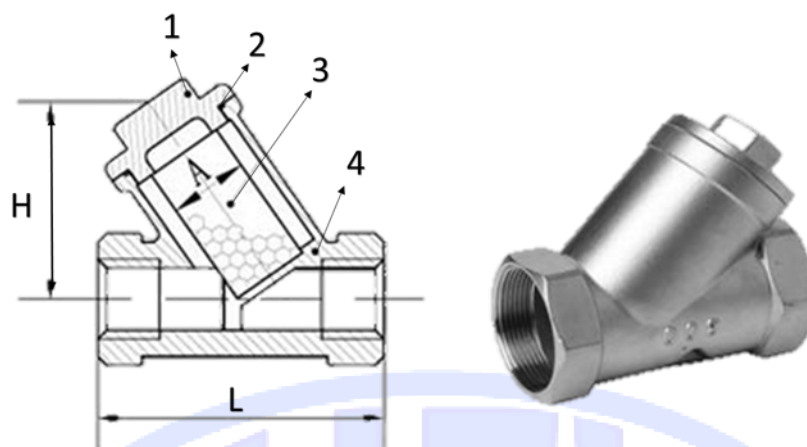

MATERIALS DATA

Size	A	L	H
1/4"	24	64	44
3/8"	24	64	44
1/2"	26	65	44
3/4"	32	76	52
1"	41	90	64
1-1/4"	49	103	68
1-1/2"	56	118	76
2"	69	140	88

No.	PARTS	MATERIAL
1	CAP	CF8M
2	GASKET	PTFE
3	SCREEN	SS
4	BODY	CF8M

OPERATING PARAMETER

Nominal Pressure	1.6Mpa
Operating Temperature	-10 to 180 Deg C
Applicable Media	Full Range of Fluid and Gas

SPECIFICATIONS — SWING CHECK VALVE

STAINLESS STEEL 316 SWING CHECK VALVE

CHEW SS316 is mounted with a disc that swings on a hinge or shaft. The disc swings off the seat to allow forward flow and when the flow is stopped, the disc swings back onto the seat to block reverse flow.

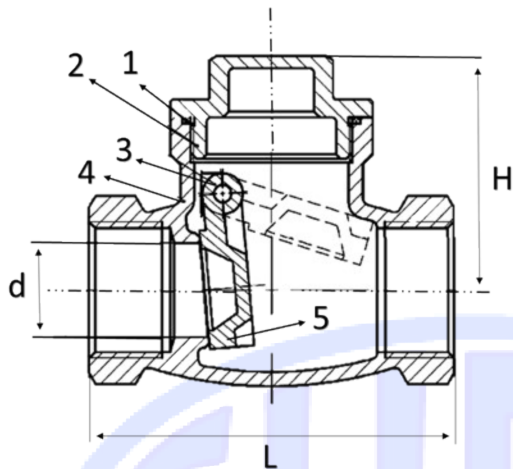

MATERIALS DATA

Size	d	L	H
1/2"	15	64	41.5
3/4"	20	83	46
1"	25	90	54
1-1/4"	32	105	58
1-1/2"	40	120	66.5
2"	50	140	74
2-1/2"	64	165	89
3"	76	185	102.5

No.	PARTS	MATERIAL
1	BONNET	CF8M
2	PLUG GASKET	PTFE
3	HANGER PIN	CF8M
4	BODY	CF8M
5	DISC	CF8M

OPERATING PARAMETER

Nominal Pressure	1.4Mpa
Operating Temperature	-20 to 180 Deg C
Applicable Media	WOG & Steam

SPECIFICATIONS — SAFETY VALVE

STAINLESS STEEL 316 SAFETY VALVE WITH LEVER HANDLE

CHEW SS316 Safety valves are used in Oil System, High Temperature Pipe System and Various Caustic Piping Systems.

After installation, the safety valves will work automatically when the pressure of medium in the system is reaching the set value. It released the pressure to protect the system.

MATERIALS DATA

No.	PARTS	MATERIAL
1	CAP	SS316
2	LEVER	SS316
3	NUT	SS316
4	ADJUST SCREW	SS316
5	SPINDLE	SS316
6	SPRING	SS316
7	VALVE BODY	SS316
8	SPRING SEAT	SS316
9	DISC	SS316
10	GASKET	PTFE
11	GASKET RING	PTFE
12	VALVE SEAT	SS316

OPERATING PARAMETER

Operating Pressure	0.1 - 35 Barg
Operating Temperature	-60 to 120 Deg C

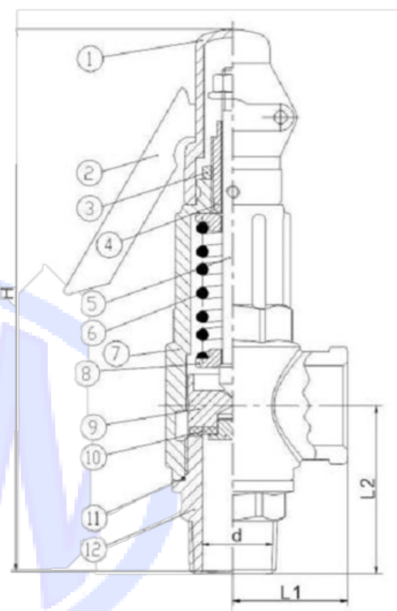

Size	d	Outlet	Lift	L1	L2	H
1/2"	13	1/2"	0.5	32.5	47	162
3/4"	16	3/4"	0.7	36.5	56	187
1"	23	1"	0.9	41.5	65	207
1-1/4"	30	1-1/4"	1.2	50.5	73	239
1-1/2"	34	1-1/2"	1.4	54.5	89	256
2"	43	2"	1.8	62.5	96	293

SPECIFICATIONS — SAFETY VALVE

STAINLESS STEEL 316 SAFETY VALVE

CHEW SS316 Safety valves are used in Oil System, High Temperature Pipe System and Various Caus-tic Piping Systems.

After installation, the safety valves will work automatically when the pressure of medium in the sys-tem is reaching the set value. It released the pressure to protect the system.

MATERIALS DATA

No.	PARTS	MATERIAL
1	CAP	SS316
2	NUT	SS316
3	ADJUST SCREW	SS316
4	SPINDLE	SS316
5	SPRING	SS316
6	VALVE BODY	SS316
7	SPRING SEAT	SS316
8	DISC	SS316
9	GASKET	PTFE
10	GASKET RING	PTFE
11	VALVE SEAT	SS316

OPERATING PARAMETER

Operating Pressure	0.1 - 35 Barg
Operating Temperature	-60 to 120 Deg C

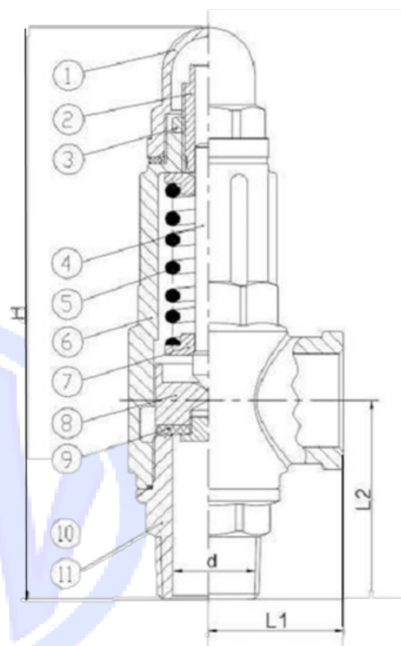

Size	d	Outlet	Lift	L1	L2	H
1/2"	13	1/2"	0.5	31.5	47	137
3/4"	16	3/4"	0.7	35	56	161
1"	23	1"	0.9	43.5	65	184
1-1/4"	30	1-1/4"	1.2	55	73	225
1-1/2"	34	1-1/2"	1.4	58	89	242
2"	43	2"	1.8	70	96	270

SPECIFICATIONS — SAFETY VALVE

BRONZE SAFETY VALVE WITH LEVER

CHEW Bronze Safety valves are used in Steam System, Boiler, Oil System, Water System, Air system as well as other standard application.

After installation, the safety valves will work automatically when the pressure of medium in the system is reaching the set value. It released the pressure to protect the system.

MATERIALS DATA

No.	PARTS	MATERIAL
1	CAP	BRONZE
2	LEVER	SS304
3	NUT	BRASS
4	ADJUST SCREW	BRASS
5	SPINDLE	BRASS
6	SPRING	SS304
7	VALVE BODY	BRONZE
8	SPRING SEAT	BRASS
9	DISC	BRASS
10	GASKET	PTFE
11	BUFFER	BRASS
12	GASKET RING	PTFE
13	VALVE SEAT	SS316

OPERATING PARAMETER

Operating Pressure	0.1 - 35 Barg
Operating Temperature	-60 to 120 Deg C

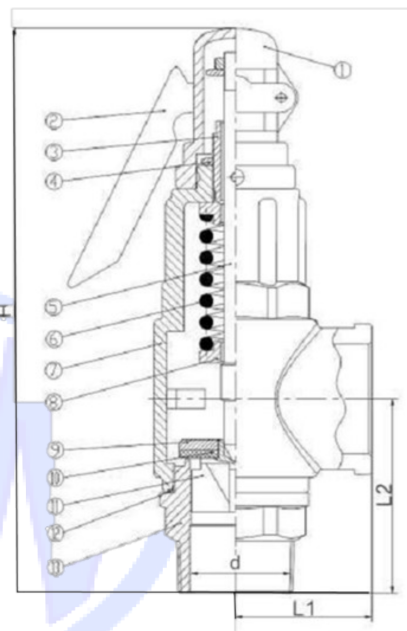

Size	d	Outlet	Lift	L1	L2	H
3/8"	10	3/8"	0.4	27	38	144
1/2"	13	1/2"	0.5	31	48	157
3/4"	19	3/4"	0.7	35	55	167
1"	25	1"	0.9	39.5	65	199
1-1/4"	32	1-1/4"	1.2	50.5	75	221
1-1/2"	37	1-1/2"	1.4	59	86	247
2"	47	2"	1.8	67	100	284

SPECIFICATIONS — SAFETY VALVE

BRONZE SAFETY VALVE

CHEW Bronze Safety valves are used in Steam System, Boiler, Oil System, Water System, Air system as well as other standard application.

After installation, the safety valves will work automatically when the pressure of medium in the system is reaching the set value. It released the pressure to protect the system.

MATERIALS DATA

No.	PARTS	MATERIAL
1	CAP	BRONZE
2	NUT	BRASS
3	ADJUST SCREW	BRASS
4	SPINDLE	BRASS
5	SPRING	SS304
6	VALVE BODY	BRONZE
7	SPRING SEAT	BRASS
8	DISC	BRASS
9	GASKET	PTFE
10	BUFFER	BRASS
11	GASKET RING	PTFE
12	VALVE SEAT	SS316

OPERATING PARAMETER

Operating Pressure	0.1 - 35 Barg
Operating Temperature	-60 to 120 Deg C

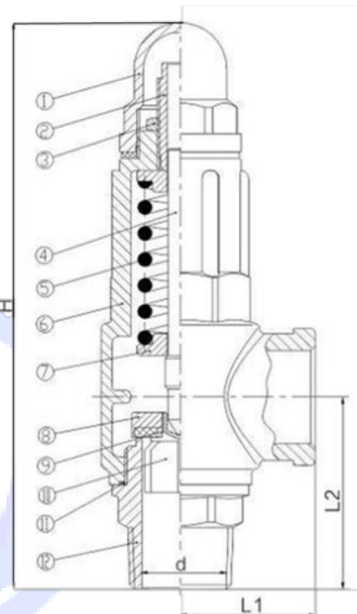

Size	d	Outlet	Lift	L1	L2	H
3/8"	10	3/8"	0.4	27	38	117
1/2"	13	1/2"	0.5	31	48	135
3/4"	19	3/4"	0.7	35	55	144
1"	25	1"	0.9	39.5	65	175
1-1/4"	32	1-1/4"	1.2	50.5	75	197
1-1/2"	37	1-1/2"	1.4	59	86	223
2"	47	2"	1.8	67	100	257

SPECIFICATIONS — BALL VALVE

100% BRASS 2PCS BODY BALL VALVE—FULL BORE

CHEW Brass Ball Valve are used for Air, Water, Oil and Acid Piping Systems which are installed where a simple on/off action is needed.

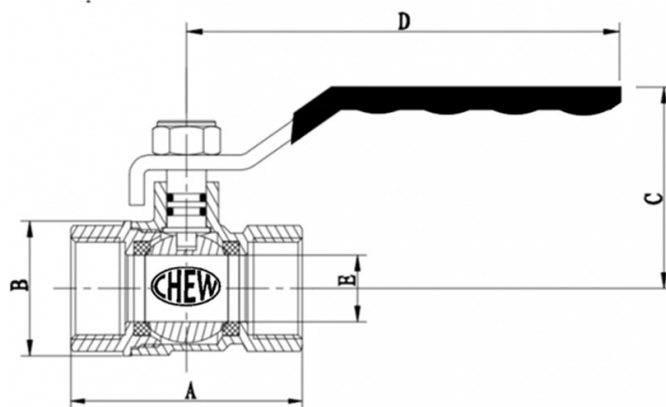

IN MM	1/4"	3/8"	1/2"	3/4"	1"	1-1/4"	1-1/2"	2"	2-1/2"	3"	4"
A	45	45.8	59.4	67	77	93	99	117	143	165	190
B	23	23	29.5	35.5	42.7	53	63	79	102.5	120.5	144.5
C	39.2	39.8	54.2	57.6	60.6	75.8	81.3	88.5	121.5	129.5	141
D	87	87	95	95	126	140	140	165	224	224	283.5
E	9	10	14.8	19	24	30.2	37	47	62	74	90
PN	25	25	25	25	25	25	25	25	25	25	25

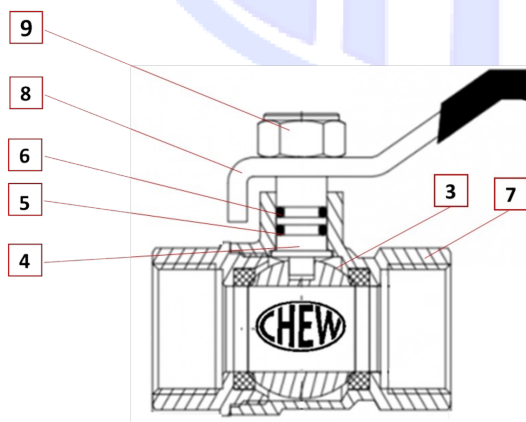

No.	PARTS	MATERIAL
1	END ADAPTER	BRASS
2	SEAT	PTFE
3	BALL	CHROME PLATED BRASS
4	STEM	BRASS
5	O-RING	NBR
6	O RING	VITON
7	BODY	BRASS
8	HANDLE	ZINC PLATED
9	LOCK NUT	ZINC PLATED

OPERATING PARAMETER

Nominal Pressure	PN25
Operating Temperature	'- 10°C to 120°C
Applicable Media	Water, Oil, Air